

ASSEMBLY INSTRUCTION

Style #AC6064

Accent Chair

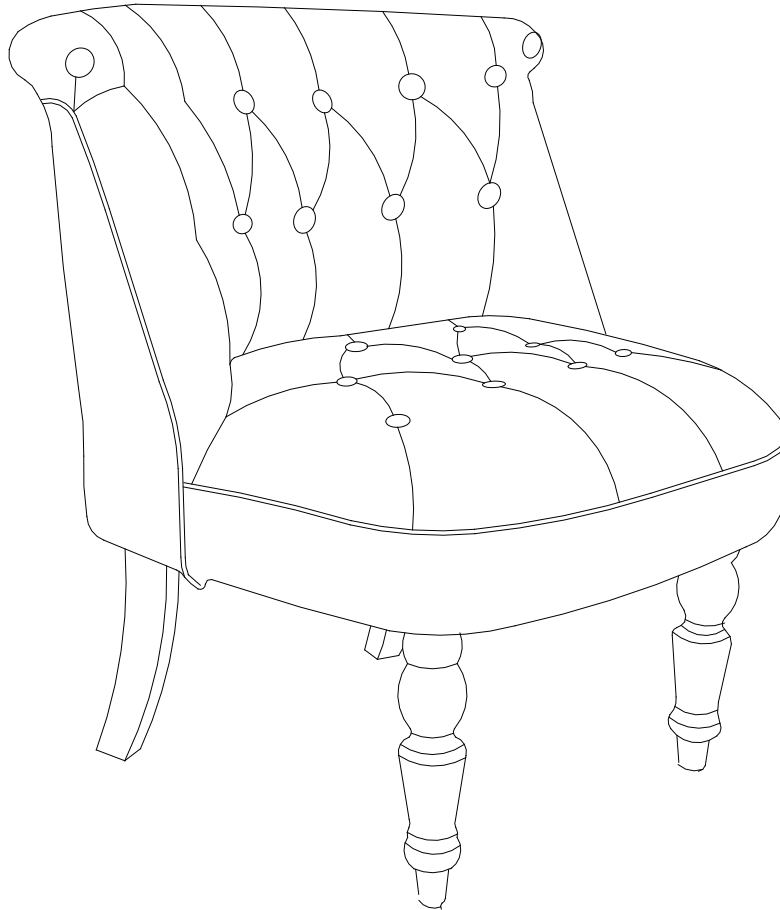

NOTE TO CUSTOMERS:

- 1).For ease and speed of aseembly we recommend that befor you commence each step of the assembly that you identify all the parts required to complete that step.
- 2).We recommend that where possible you allow sufficient space to assemble the item as close as possible to the place where it will be once assembled.
- 3). For the protection of your furniture we recommend that the product is placed on protected surfaces during assembly to prevent damage.
- 4).During assembly do not over tighten, as this may damage the product.
- 5).Please ensure you retain all the product packaging until the item completely assembled.
- 6).Please periodically check alll fitting and re-tighten as necessary.
- 7).It is recommended that this items should be assembled by two adults.

ASSEMBLY INSTRUCTION

ITME NO.AC6064

| | | | | | | | | | |
|----------|------------------|----------|---------------|----------|----------------|----------|----------|----------|----------|
| A | M8*2-3/8"L x4 | B | M8*7/8" x4 | C | M6*3/4"L x8 | D | M8 x1 | E | M6 x1 |
|----------|------------------|----------|---------------|----------|----------------|----------|----------|----------|----------|

STEP1

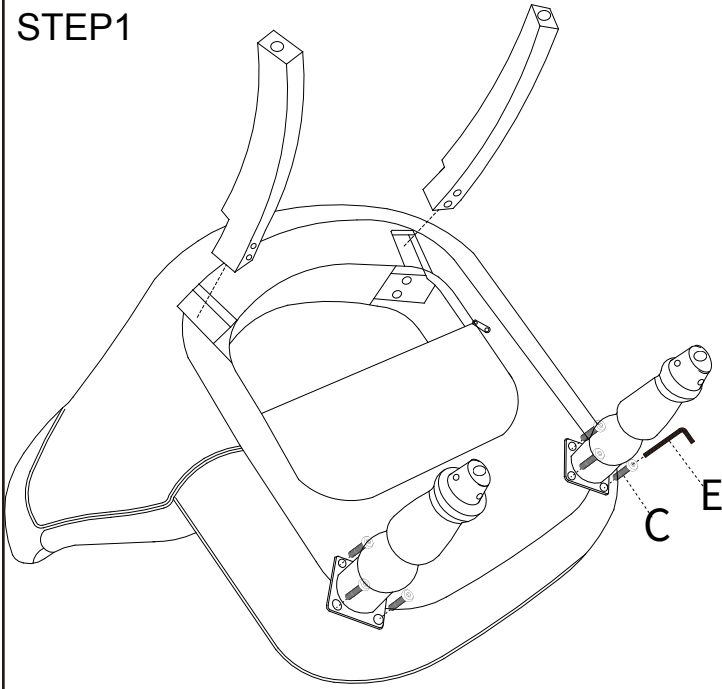

Do not tighten bolts (C) until step 4.

STEP2

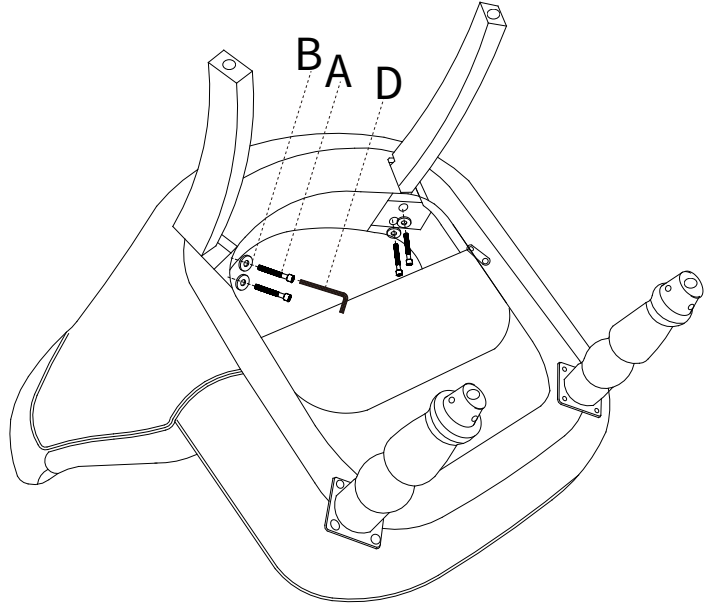

Do not tighten bolts (A) until step 4.

STEP3

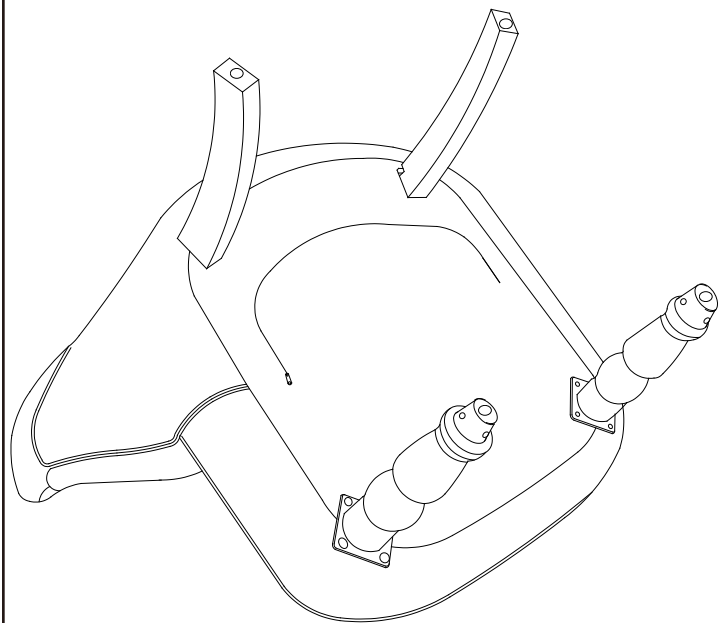

STEP4

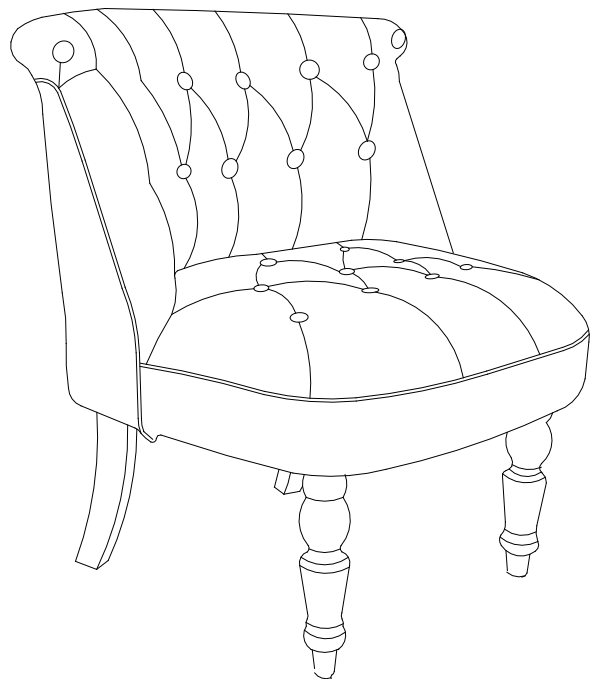

Place the chair on the floor to check if it is stable before tighten all bolts (A) & (C).